

Getting Started

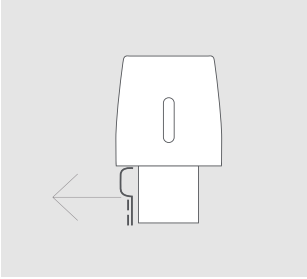

PREPARE

Remove the seal tab before using VEEV pod.

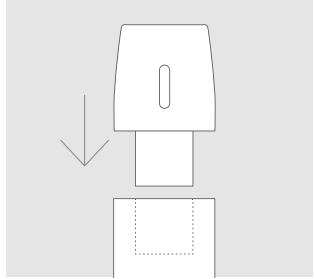

INSERT

Insert the VEEV pod into your VEEV device. A quick vibration and light pulse will confirm the VEEV pod is correctly inserted.

VEEV

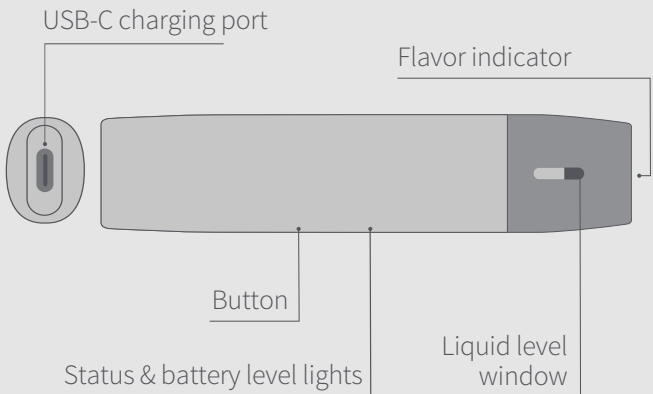

How To Use

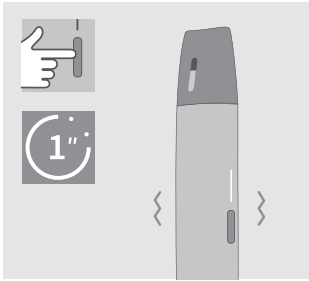

VAPE

Press the button for 1 second to turn on the device for first use. Once the lights stop pulsing, they will become constant white and show the battery level. You can start vaping.

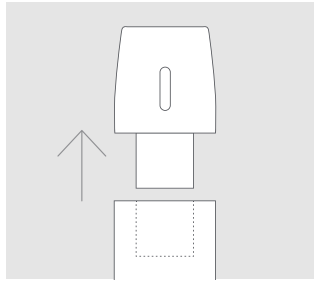

CHANGE VEEV POD

You don't need to turn off your VEEV device before removing the VEEV pod. When you insert it, a pulsing light might appear to indicate that it is initializing. It is ready to use when the light stops pulsing.

Seal tab
(to be removed)

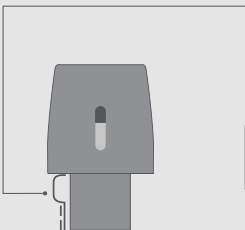

VEEV pod
(sold separately)

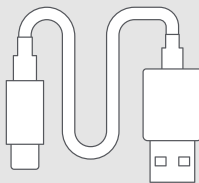

Charging cable*

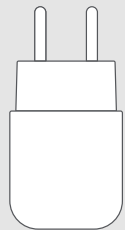

AC power adaptor

Use only a dry cloth to clean the mouth end of device.

* For optimal charging performance, only use a manufacturer-approved AC power adaptor (sold separately).

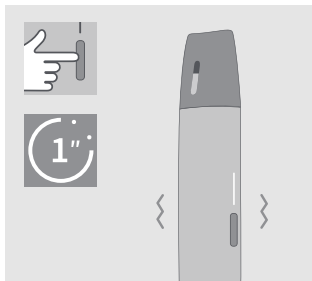

If you wait more than 1 minute to insert the VEEV pod, your VEEV device will automatically switch off to save battery. You will need to press the button for 1 second after inserting the VEEV pod to start vaping.

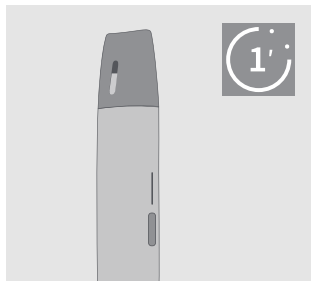

TURN OFF

If you don't use your VEEV device, it will automatically turn off after 1 minute to save battery. Alternatively, you can turn off your VEEV device by pressing the button for 1 second until it vibrates and the light turn off.

CUSTOMER CARE

For the full user guide, customer care and extended support services, visit

[Veev-vape.com](http://veev-vape.com)

ENGAGE WITH VEEV

Download VEEV app on Google Play or on veev-vape.com to access additional features.



* Google Play and the Google Play Logo are trademarks of Google LLC.

* VEEV app may not be available in your country.

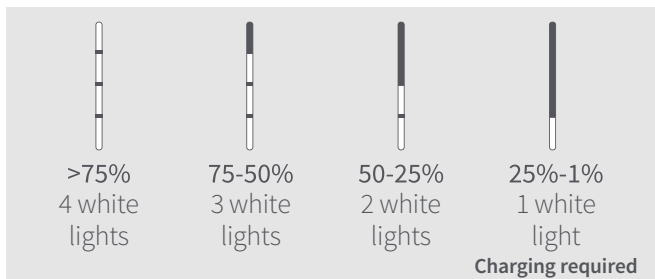

BATTERY LEVELS

White lights show the battery level. When VEEV battery is empty, the lower white light will blink for a few seconds before turning off.

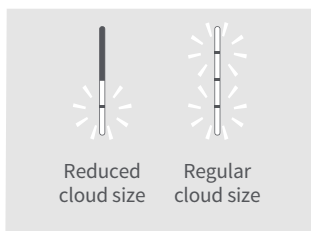
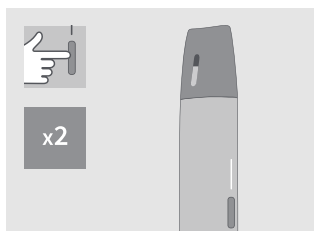

CLOUD SIZE ADJUSTMENT

Press the button twice quickly to set the cloud size. While the lights are rapidly pulsing, press the button twice again to choose between two cloud sizes. Pulsing lights and vibrations will indicate active mode. VEEV device will automatically leave the cloud size settings 5 seconds after the last double press of the button or after taking a puff.

Quick Tips

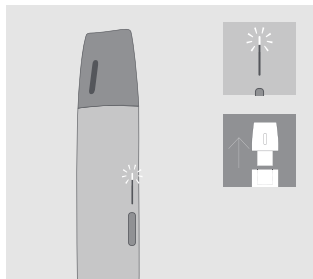

LOW LIQUID DETECTION

VEEV device will show the upper white light blinking for a few seconds before turning off. This is designed to prevent overheating and burnt taste. Replace the VEEV pod when this happens.

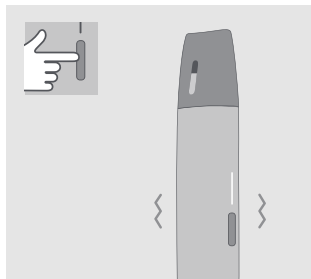

TO TURN ON & OFF RESPONSIVE DRAW

The responsive enhances the sensorial experience through a subtle vibration while puffing. Quickly press on the button while taking a puff to turn it on or off.

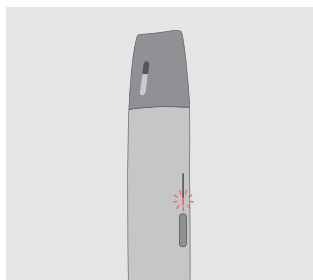

ERROR NOTIFICATION

VEEV device will show a red light blinking for a few seconds. Try to change the VEEV pod. If this happens again, perform a reset.

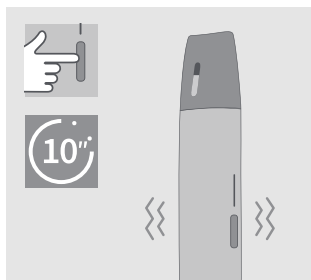

TO RESET

Press the button for approximately 10 seconds and release. A few vibrations and blinkings of the lights will confirm the reset of your VEEV device.

VEEV



This symbol indicates that caution is required when operating the product.

ENGLISH

SAFETY WARNINGS AND INSTRUCTIONS

PLEASE READ ALL SAFETY INFORMATION AND INSTRUCTIONS BEFORE USE TO AVOID INJURY.

These safety warnings and instructions cannot cover all possible conditions that could occur and users should exercise care and caution.

KEEP THESE INSTRUCTIONS FOR FUTURE REFERENCE AS THEY CONTAIN IMPORTANT SAFETY INFORMATION.

Intended users

- VEEV™ device and VEEV pods are for adult use only.
- VEEV device and VEEV pods are for current adult e-cigarette users and smokers who would otherwise continue to use tobacco or nicotine-containing products.
- Children and adolescents should never use VEEV device or VEEV pods under any circumstances.
- VEEV device or VEEV pods should not be used by persons with reduced physical, sensory or mental capabilities or lack of knowledge, unless they have been given supervision or instruction to use the product in a safe way and understand the hazards involved.

Nicotine

- VEEV™ pods contain nicotine, which is addictive.
- VEEV device and VEEV pods are not risk-free. The best way to reduce nicotine-related health risks is to quit tobacco and nicotine use altogether.
- Some consumers of VEEV reported experiencing (in alphabetical order) abdominal pain, cough dizziness, dry mouth, headache, malaise, nasal stuffiness, nausea, mouth irritation, throat irritation, vomiting.
- Nicotine-containing products should not be used by people who have or are at risk of heart disease, are diabetic, are epileptic or are experiencing seizures.
- Nicotine-containing products should not be used during pregnancy or while breast-feeding. If you are pregnant, breast-feeding, or think you may be pregnant you should quit tobacco and nicotine use altogether.
- Stopping smoking or switching to VEEV device and VEEV pods or other nicotine-containing products may require the adjustment of the dosing of certain medicines (e.g. theophylline, clozapine, ropinirole).
- If you have questions about whether you should use VEEV device or VEEV pods given an existing health condition, you should consult a health care professional.

▲ IMPORTANT SAFETY INFORMATION

▲ WARNING CHOKING AND INGESTION HAZARD

- Keep VEEV device and VEEV pods out of reach of children and pets at all times.
- CHOKING HAZARD — VEEV device and VEEV pods contain small parts.
- INGESTION HAZARD — If VEEV device or VEEV pods or their parts are swallowed, seek medical attention immediately due to risk of nicotine intoxication.

▲ WARNING ELECTRICAL AND BATTERY HAZARD

Electrical risks

Failure to follow these Safety Warnings and Instructions could result in fire, explosion, electric shock, injury, or damage to the product or other property:

- Only Intended Users should use VEEV™ device.
- Do not use VEEV where the use of electronic devices is prohibited.
- Do not charge or use VEEV or accessories if damaged, tampered with or broken.
- Do not use VEEV if its battery appears to be leaking.
- Only charge VEEV using the USB Cable and a manufacturer-approved AC Power Adaptor. Do not use accessories not approved by manufacturer. Refer to 'Technical Data' section and www.veev-vape.com for details.
- Do not use, charge, or store VEEV in places with high temperature (such as inside a car in summer, or near heat sources such as radiators or fireplaces).
- Do not use VEEV where flammable materials, liquids and gasses are present.
- VEEV device, AC Power Adaptor and USB Cable should not be exposed to any liquid. Do not touch them if they become wet or have been immersed in any liquid.

- Never dispose of VEEV with other household waste, as it may enter in contact with water and/or other liquids.
- Clean the USB charging port periodically to avoid accumulation of foreign matters (such as dust particles), and inspect USB port for foreign materials before using USB connector.
- Disconnect VEEV and/or its accessories from any source of power if it overheats, fumes, ignites, or burns while charging.
- Do not touch VEEV and/or its accessories if they overheat, fume, ignite, or burn.
- Handle with care. Do not drop VEEV or subject it to strong shock.
- This product contains no user-serviceable parts. Do not attempt to open, modify, service, disassemble or repair any component of VEEV device or to replace any of the components or batteries.

Battery risks

VEEV™ device is powered with sealed Lithium-ion (Li-on) batteries. Under normal conditions of use, the battery is sealed. If you notice that battery fluid leaks, follow these precautions:

- If fluid from leaked battery is swallowed, seek medical attention immediately. Do not induce vomiting or ingest food or drink.
- If vapor from leaked battery liquid is inhaled, get fresh air and seek medical attention.
- If fluid from leaked battery is in contact with skin, wash hands and do not touch eyes.
- If fluid from leaked battery is in contact with eyes, immediately flush with running water for at least 15 minutes and seek medical attention immediately.

▲ CAUTION Allergic reaction risk

- Using VEEV device and VEEV pods could cause an allergic reaction, such as swelling of the face, lips, tongue, gums, throat, or body, difficulty breathing, or wheezing.
- Stop using VEEV device and VEEV pods and seek medical attention immediately if you experience any of the symptoms above as they may indicate a serious allergic reaction.

Exclusive use of VEEV pods

- Only use VEEV pods with VEEV device. Never use VEEV device with other pods. Doing so may cause injury.
- Do not modify or attempt to refill VEEV pods in any way or add any substance to VEEV pods. Doing so may cause injury

Usage & Storage

- Do not expose this product to excessive heat or moisture.
- It is recommended to use the product between 0°C-40°C.
- Store in a place inaccessible to children.

Reporting of adverse events or incidents

- If you experience any unwanted health effect when using VEEV, consult a health care professional.
- You can report any adverse event or incident directly by contacting your local Call Center (details can be found in the Customer Care & Warranty booklet). By reporting side effects, you can help provide more information on the safety of this product.
- For more information please go to www.veev-vape.com.

TECHNICAL DATA

VEEV Kit

Electronic nicotine delivery system for multiple use with Bluetooth® technology. Manufacturer: Philip Morris Products S.A., Quai Jeanrenaud 3, 2000, Neuchatel, Switzerland. Importer: Philip Morris Zagreb d.o.o., Heinzelova 70, 10000 Zagreb.

This kit includes:

VEEV Device

Model B-1603

Bluetooth 4.2

Battery type: Li-ion Rechargeable Battery (360 mAh)

Input: 5V  2A

The VEEV™ device is marked with the symbol  followed by "SxxAxx," which indicates the VEEV device can only be charged using one of the approved Power Adaptor models listed below.

AC Power Adaptor:

Model: S52A21, S21A20, S21A22, S21A23, S21A25, S21A27, S82A40, S82A41, S82A42, S82A43, S82A45, S82A46.

Input: 100V-240V~ 50/60Hz 0.3A

Output: 5.0V (CPI-RRP-VAR-0949) 2.0A

Output power: 10.0W

Average active efficiency: 79.0%

No load power consumption: <0.09 W

Use with Charging Cable.

Confirmation of Compliance

Hereby, Philip Morris Products S.A. declares that VEEV is in compliance with the essential requirements and other relevant provisions of Directive 2014/53/EU. The official Declaration of Conformity may be found at: www.pmi.com/declarationofconformity



VEEV device Model B-1603 operates within 2.402 – 2.480 GHz frequency band with a maximum RF output power below 10.0 dBm.



The Bluetooth® word mark and logos are registered trademarks owned by Bluetooth SIG, Inc. and any use of such marks by Philip Morris Products S.A. and its affiliates is under license.

Further information regarding the firmware license for VEEV device is available on www.veev-vape.com

INFORMATION ON DISPOSAL



VEEV device and its elements (including batteries) must not be disposed together with household waste. Instead, you should dispose your used device by handing it over to a special drop-off depot for recycling of electric and electronic devices. Separate collection and disposal of used equipment (including batteries) helps to preserve nature resources and ensures protection of human health and the environment. Disposal of used equipment as unsorted household waste (for example, its burning or damping) may cause adverse consequences for the environment and human health.

For additional information about the places where you can deliver your device for recycling please contact local administration.

BATTERY REMOVAL INSTRUCTIONS (FOR DISPOSAL AND RECYCLING)

Batteries must not be removed by the consumer. Only an authorized recycler may safely remove batteries by following these steps.

VEEV™ Model B-1603:

Step 1: Check the voltage. The Device should be fully discharged before disassembling it. Press the Power Button to check if all the LED lights are off; if not, the Device should be discharged until all the LED lights are off.

Step 2: Remove the End Cap Cover attached with adhesive.

Step 3: Remove two screws (Countersink K1.8, T6).

Step 4: Remove the End Cap Part.

Step 5: Remove the Connector Part away by pushing it from the bottom and gliding it out.

Step 6: Disconnect Battery Connector by lifting it up.

Step 7: Turn the Device around and Disconnect the Battery from its slot. Battery is attached with very firm double sided adhesive directly on the top of the PCB.

Underage sale is prohibited. VEEV device should only be used with special replaceable VEEV pods (sold separately).